

HeartFelt® Wall System

PRODUCT CHARACTERISTICS:

- Modular linear felt system
- Panel dimensions 40 x 55 mm
- Panels are available in 5 shades of grey and 5 earth tones
- HeartFelt® panels can be finished using end caps.
- Panel length 1000 - 6000 mm
- 16 standard carrier modules offering different joint widths

www.hunterdouglasarchitectural.eu

© Registered trademark - a HunterDouglas® product

Project : City Hall Hasselt, Belgium
Product : HeartFelt® - Ceiling & Walls
Architect : UAUcollectiv in collaboration with Jaspers-Eyers Architects

HunterDouglas 
Architectural

SYSTEM OVERVIEW

- 1 = HeartFelt® panel 40HL55
- 2 = Carrier
- 3 = Locking strip
- 4 = Support profile (Non-HD)

PROFILE

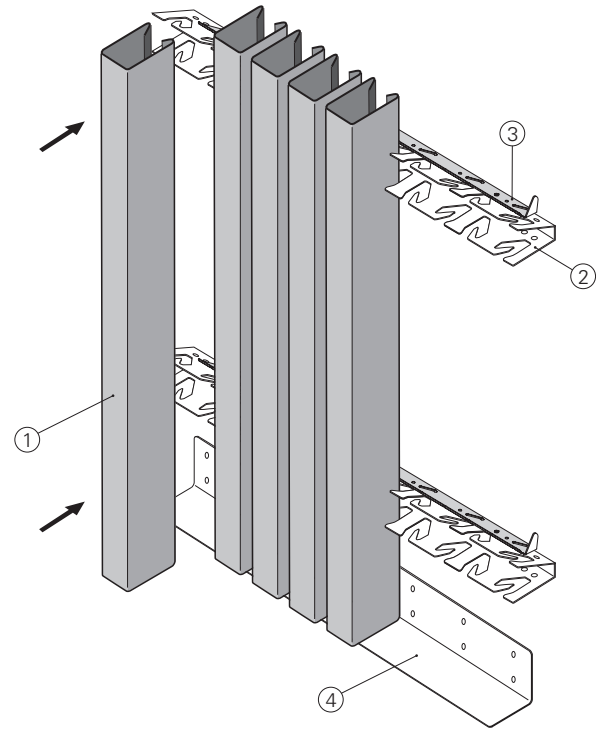
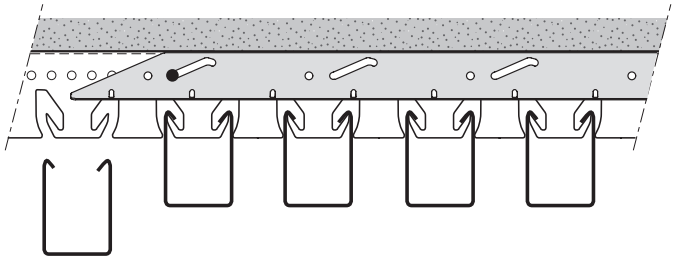

MAXIMUM SPAN

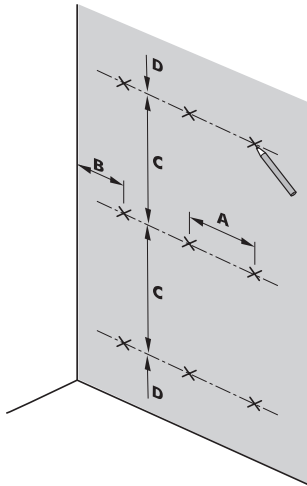

Panel	Maximum Carrier span		Maximum Panel span	
	A	B	C	D
HeartFelt® 40HL55 Wall application	750-800	300	800	150

MATERIAL PROPERTIES

- **Material:** non-woven, thermo formable PES-fibers
- **Fire retardant:** class B,s1,d0 EN 13501-1
- **Weight:** 4.6 kg/m² (M50) - 3.5 kg/m² (M100)
- **Light reflection:** depending on colour
- **Exposure class:** A and B EN 13964

CERTIFICATIONS

- Indoor Air Comfort Gold
- French VOC-regulation class A+
- Cradle to Cradle™ Level Bronze
- Oeko-tex Standard 100 klasse IV
- SundaHus Miljødata klasse A
- GreenGuard Gold



LOCKING STRIP

Open

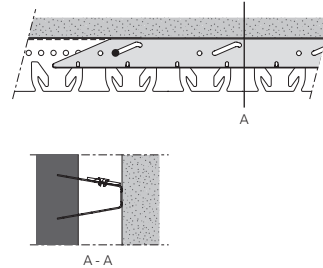

Closed

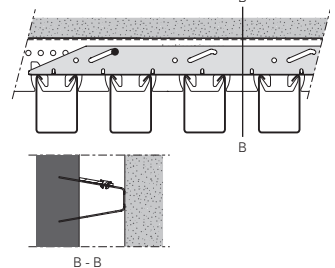

ACOUSTICS - $\alpha_w^{(1)}$

Module (mm)	Joint (mm)	Openness %	α_w
M50	10	20%	0.70 (H)
M60	20	33%	0.65 (H)
M70	30	43%	0.60 (H)
M70 ⁽²⁾	30	43%	1.00 (H)
M80	40	50%	0.50 (H)
M90	50	55%	0.45 (H)
M100	60	60%	0.45 (H)

⁽¹⁾Tested with plenum depth of 200 mm.

⁽²⁾Ceiling panels covered with mineral wool tiles or acoustic tiles from PES.

HunterDouglas 
Architectural

Hunter Douglas Architectural

Piekstraat 2
P.O. Box 5072 - 3008 AB Rotterdam - The Netherlands
Tel. +31 (0)10 - 486 99 11 - Fax +31 (0)10 - 484 79 10
www.hunterdouglasarchitectural.eu